

A BETTER FUTURE FOR BA'OAN

WHERE INNOVATION MEETS RESILIENCE: URBAN DESIGN

What innovative and sustainable urban design strategies can transform Bao'an into a resilient and climate-adaptive district, addressing heat, flooding, and pollution?

SITE LOCATION

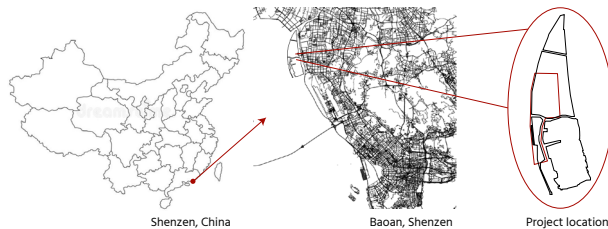

SWOT



PROBLEM STATEMENT

1. HEAT ISLAND EFFECT

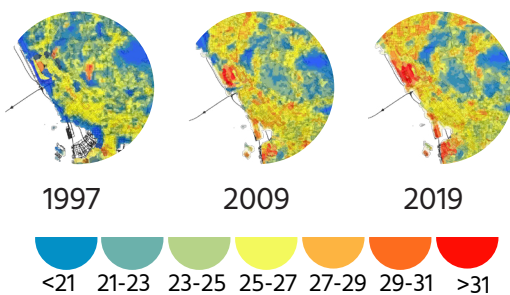

2. FLOOD RISK

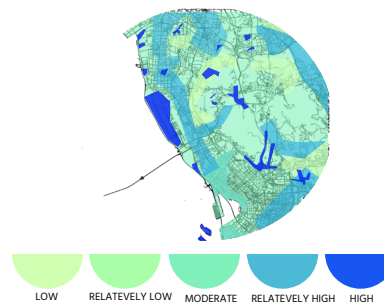

3. POLLUTION



DESIGN STRATEGIES

1 HEAT ISLAND EFFECT

- A) Greenery & Urban Forests
 - Green corridors
 - Pocket parks
- B) Materials innovation
 - Cooling surfaces
 - Reflective & permeable
- C) Passive cooling measures
 - Narrow streets
 - Natural ventilation (in building designs)

2 FLOOD RISK

- A) Water management
 - Retention ponds
 - Monitor water levels (smart drainage)
- B) Nature based solutions
 - Mangroves, wetlands
 - Bioswales
- C) Resilient infrastructure
 - Elevate infrastructure
 - Floating design

3 INDUSTRY POLLUTION

- A) Energy transition
 - Implementing solar pannels & wind turbines in industrial areas
 - Clean hydrogen power
- B) Pollution mitigation
 - Greenbelts
 - Water & air filtration (industries)
- C) Circular economy
 - Recycling hubs
 - Sharing of resources (urban farming)

VISUAL EXAMPLES

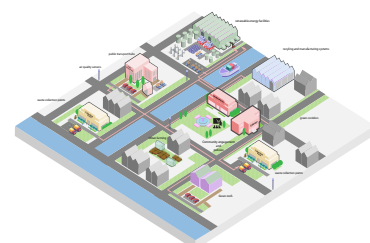
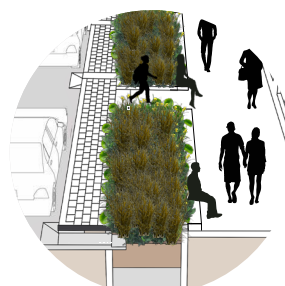

A BETTER FUTURE FOR BA'OAN

WHERE INNOVATION MEETS RESILIENCE: URBAN DESIGN

What innovative and sustainable urban design strategies can transform Bao'an into a resilient and climate-adaptive district, addressing heat, flooding, and pollution?

PROMENADE CROSS SECTION

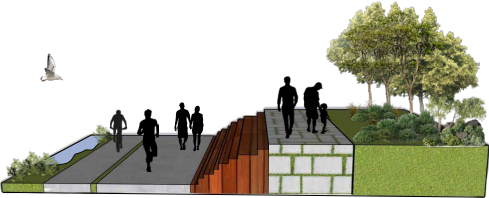

A Climate-Resilient Public Space
Shaded by trees, the promenade cools the streets, improves walkability, and enhances public life with sustainable, green infrastructure.

FLOATING HOUSES

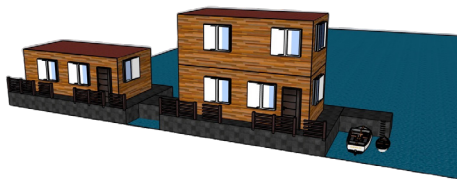

Adapting to Rising Seas
Floating homes showcase innovative, eco-friendly living with solar panels, rain-water systems, and resilience to climate change.

PORT



Sustainable Economic Hub
The port integrates clean energy and efficient waste systems, driving industrial growth while minimizing environmental impact

ZONING PLAN

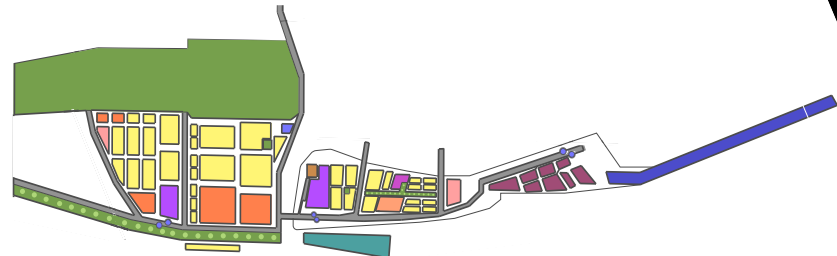

URBAN FOREST



Green Oasis for Resilience
The urban forest combats heat, boosts biodiversity, and improves air quality, creating a sustainable sanctuary for the community.

PUBLIC BUILDING

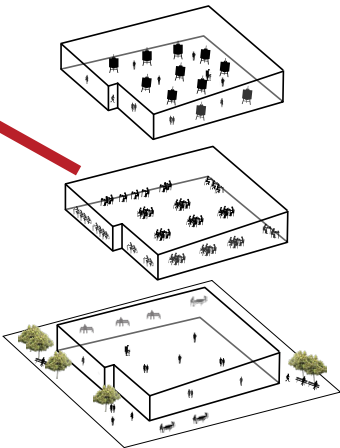

Centers of Innovation
These energy-efficient buildings host community and learning spaces, embodying Bao'an's vision for sustainable development.

USES IN ZONING PLAN

- GREEN
- RESIDENTIAL
- MIXED USE
- EDUCATION
- PUBLIC BUILDING
- RECYCLING CENTER
- FISH MARKET
- MOBILITY HUBS
- PORT
- INDUSTRIES & COMPANIES
- ROAD INFRASTRUCTURE